

I N S T R U C T I O N S



How to move
the Manual Crank
Assembly to the
other side of a
SleepSafe® Bed.



SleepSafeBed.com / 866.853.2337 / Made in USA

NOTES

PLACE BED ON SOFA BLOCKS SO YOU CAN REMOVE THE HEAD AND FOOTBOARD

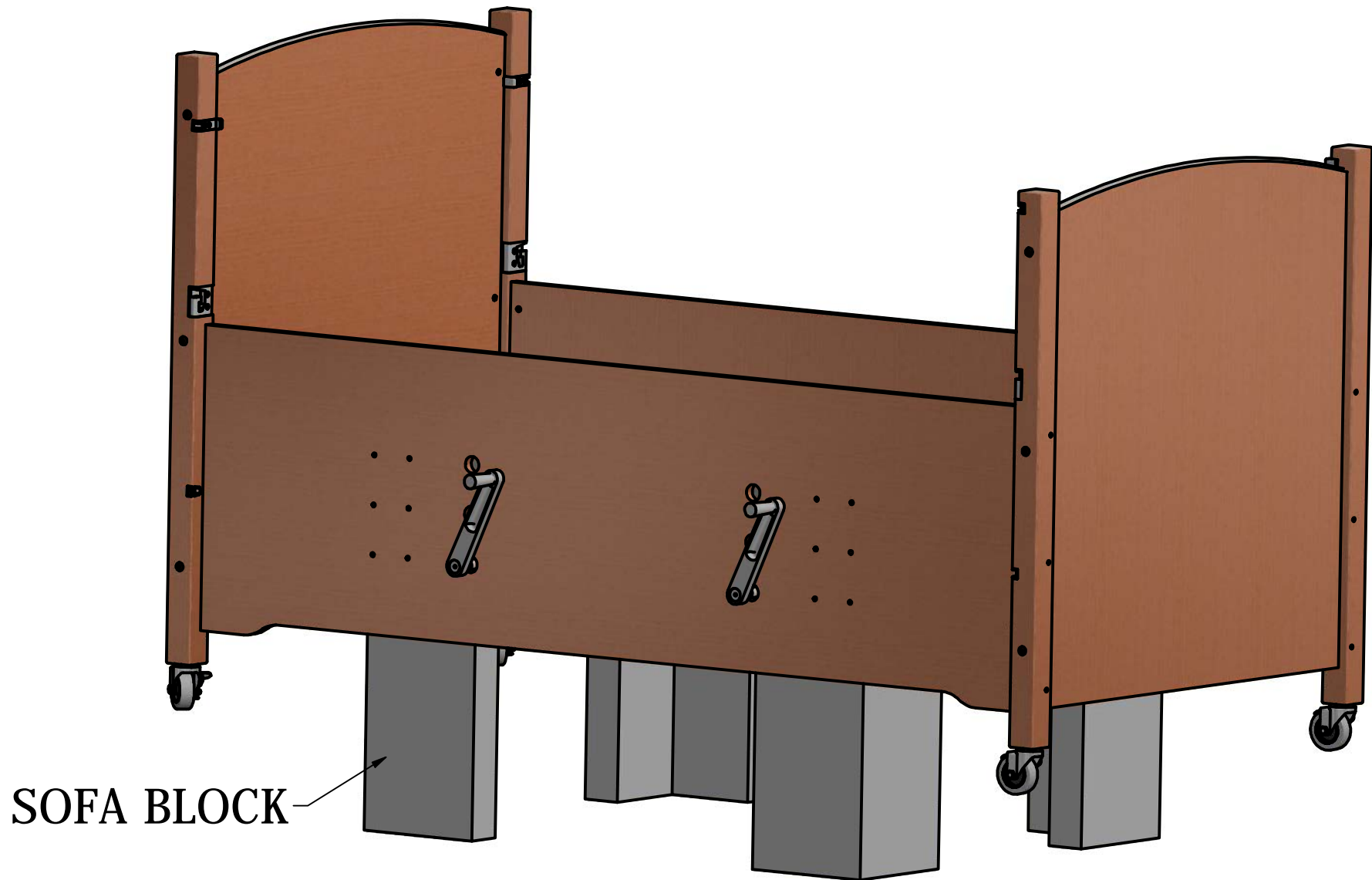

SOFA BLOCK

REV

1

Date
4/30/2019

Drawn By
Rex.Anderson

MANUAL PUMP CONVERSION STEP 1



NOTES

NEXT, REMOVE THE MANUAL CRANK HANDLES

THEN REMOVE BOTH PANELS



REV

1

Date
4/30/2019

Drawn By
Rex.Anderson

MANUAL PUMP COVERSION STEP 2



NOTES

TO MAKE THIS CONVERSION EASIER, YOU NEED TO TAKE THE FRAME OFF THE BLOCKS AND TURN OVER TO EXPOSE ALL OF THE PUMPS

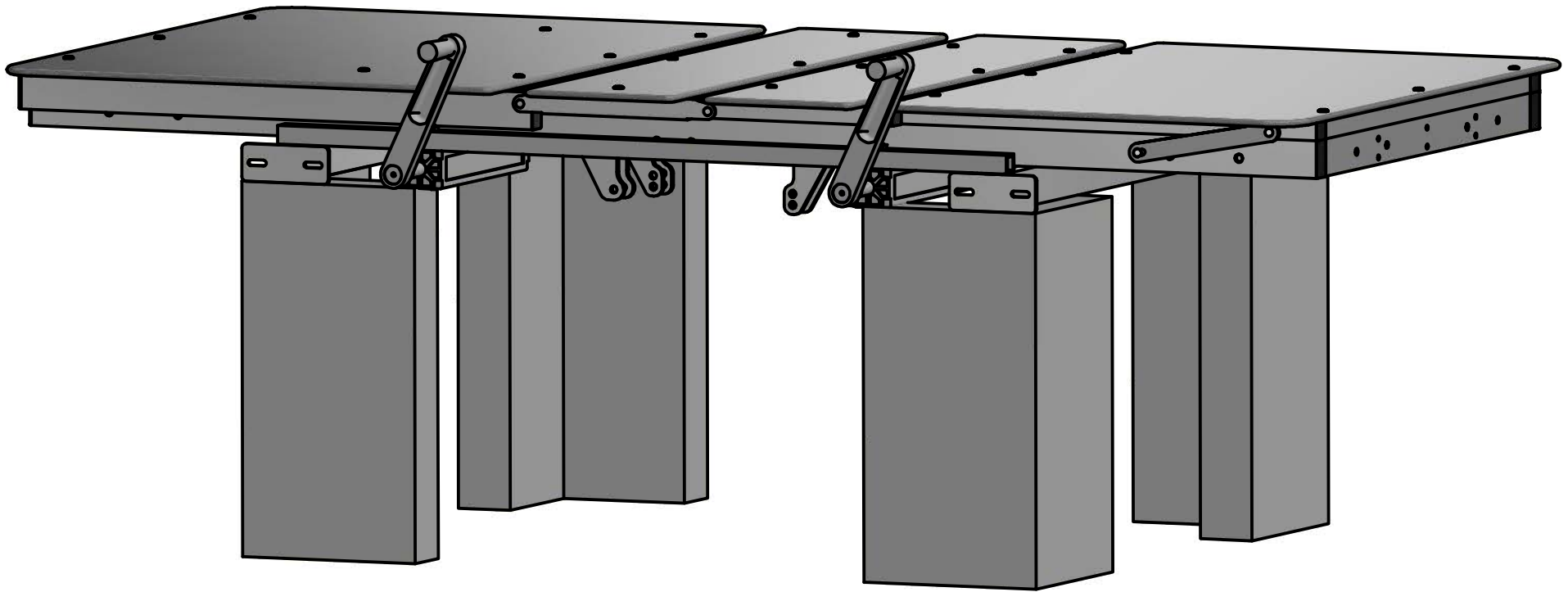

REV

1

Date
4/30/2019

Drawn By
Rex.Anderson

MANUAL PUMP CONVERSION STEP 3



NOTES

NOW, LOOSEN AND REMOVE THE MANUAL PUMP FROM THE MOUNTING BAR

MOUNTING BAR

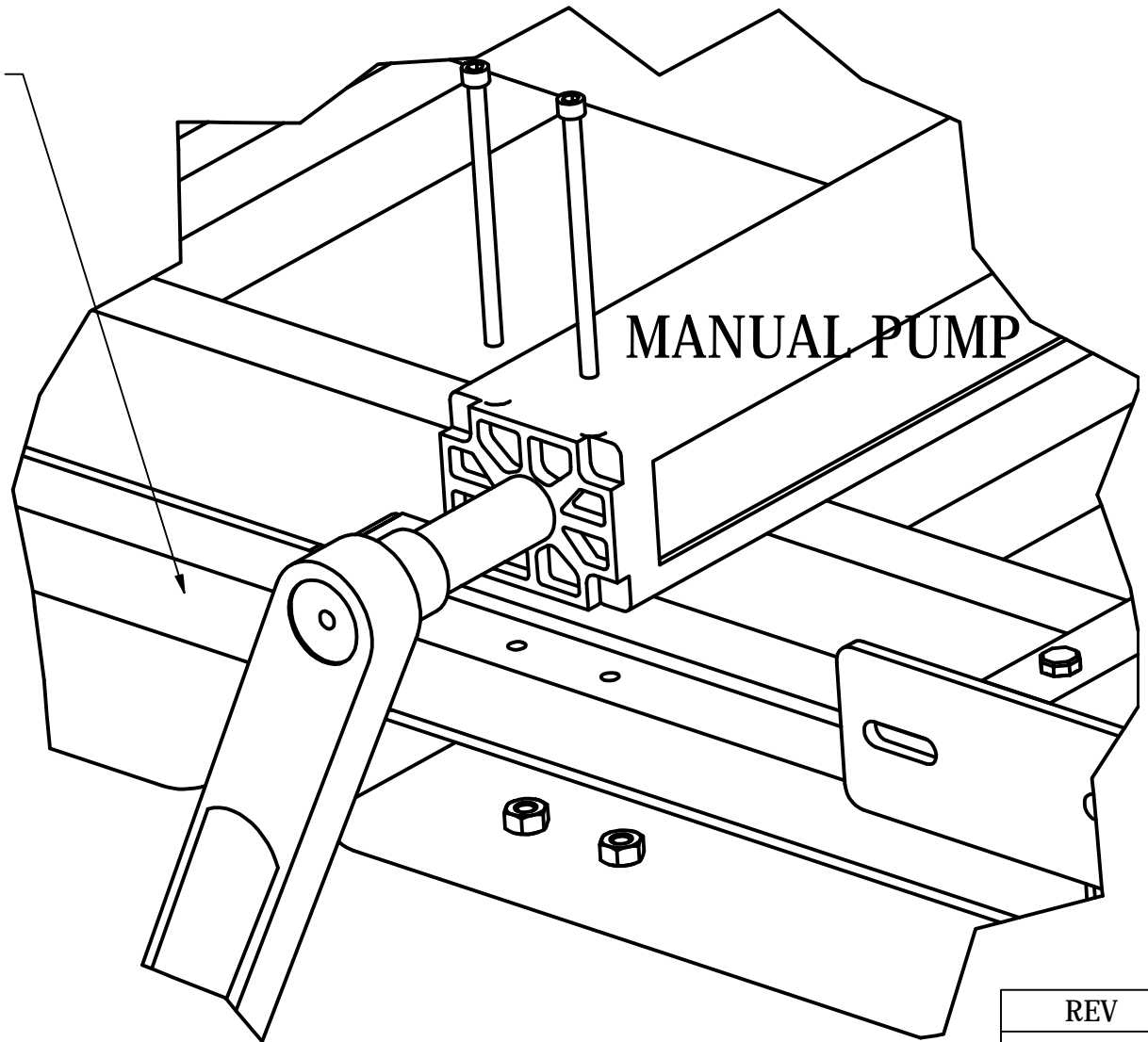
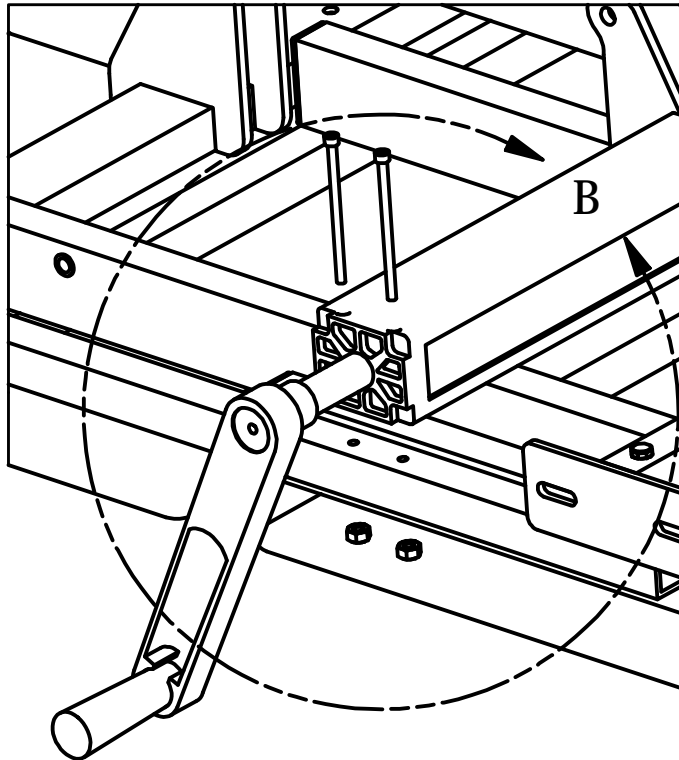

REV

1

Date
4/4/2019

Drawn By
Rex.Anderson

MANUAL PUMP CONVERSION STEP 4



NOTES

TAKE AND REMOVE THE MOUNTING BAR FROM THE PLUS BRACKET BY TAKING OUT THE 2 1/2 BOLTS

NOW MOVE AND RE-INSTALL MOUNTING BAR TO THE OTHER SIDE OF THE FRAME

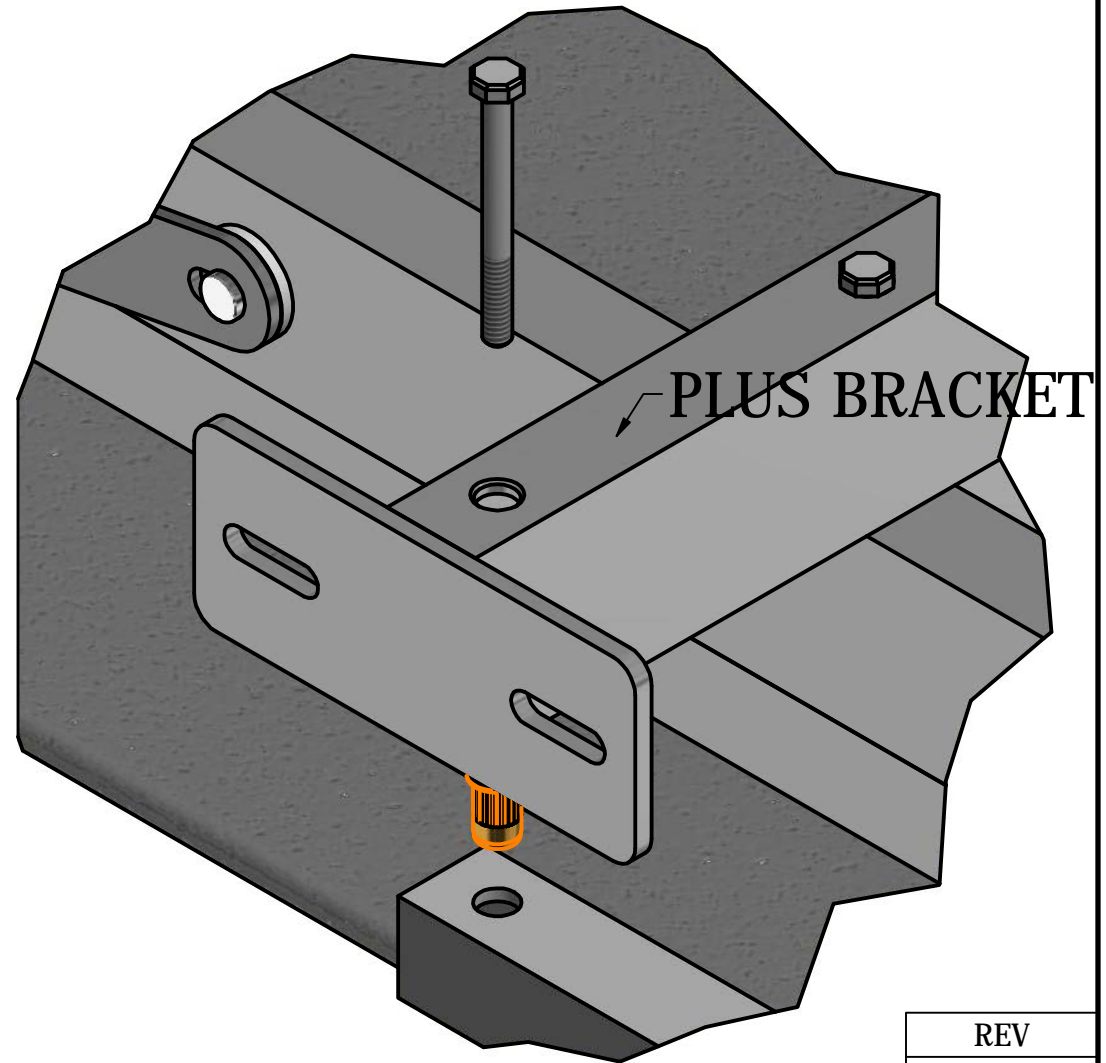
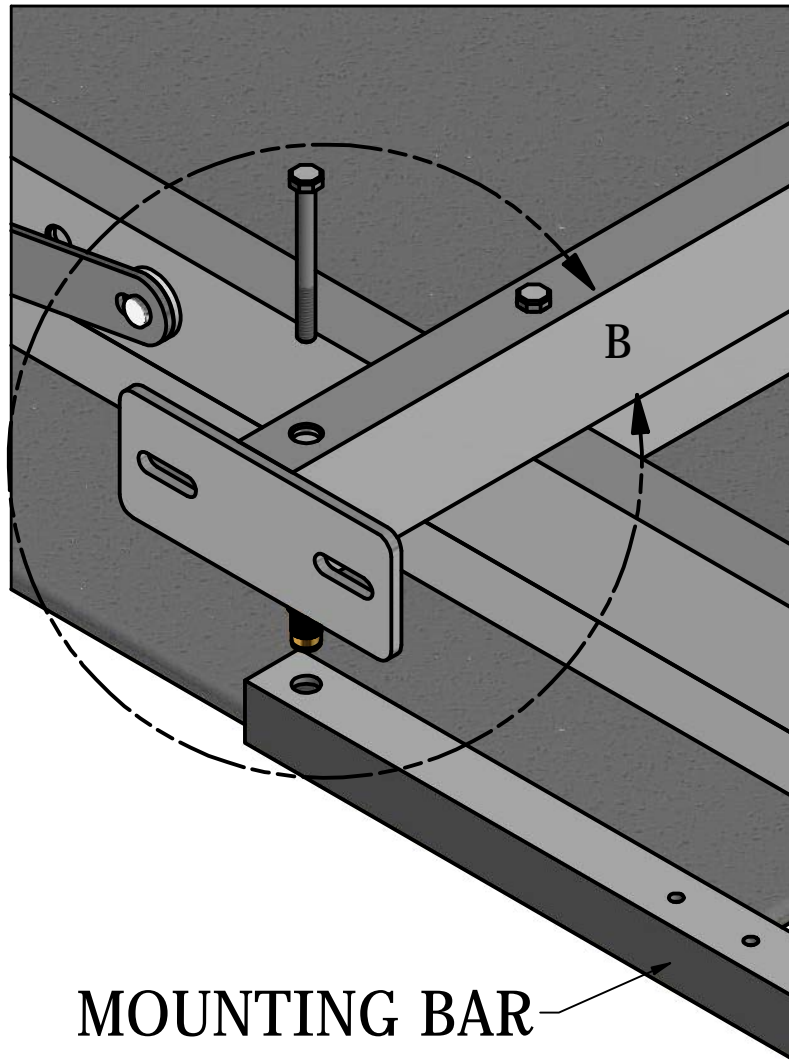

MOUNTING BAR

REV

1

Date
4/4/2019

Drawn By
Rex.Anderson

MANUAL PUMP CONVERSION STEP 5



NOTES

RE-MOUNT THE MANUAL PUMPS TO THE MOUNTING BAR

MOUNTING BAR

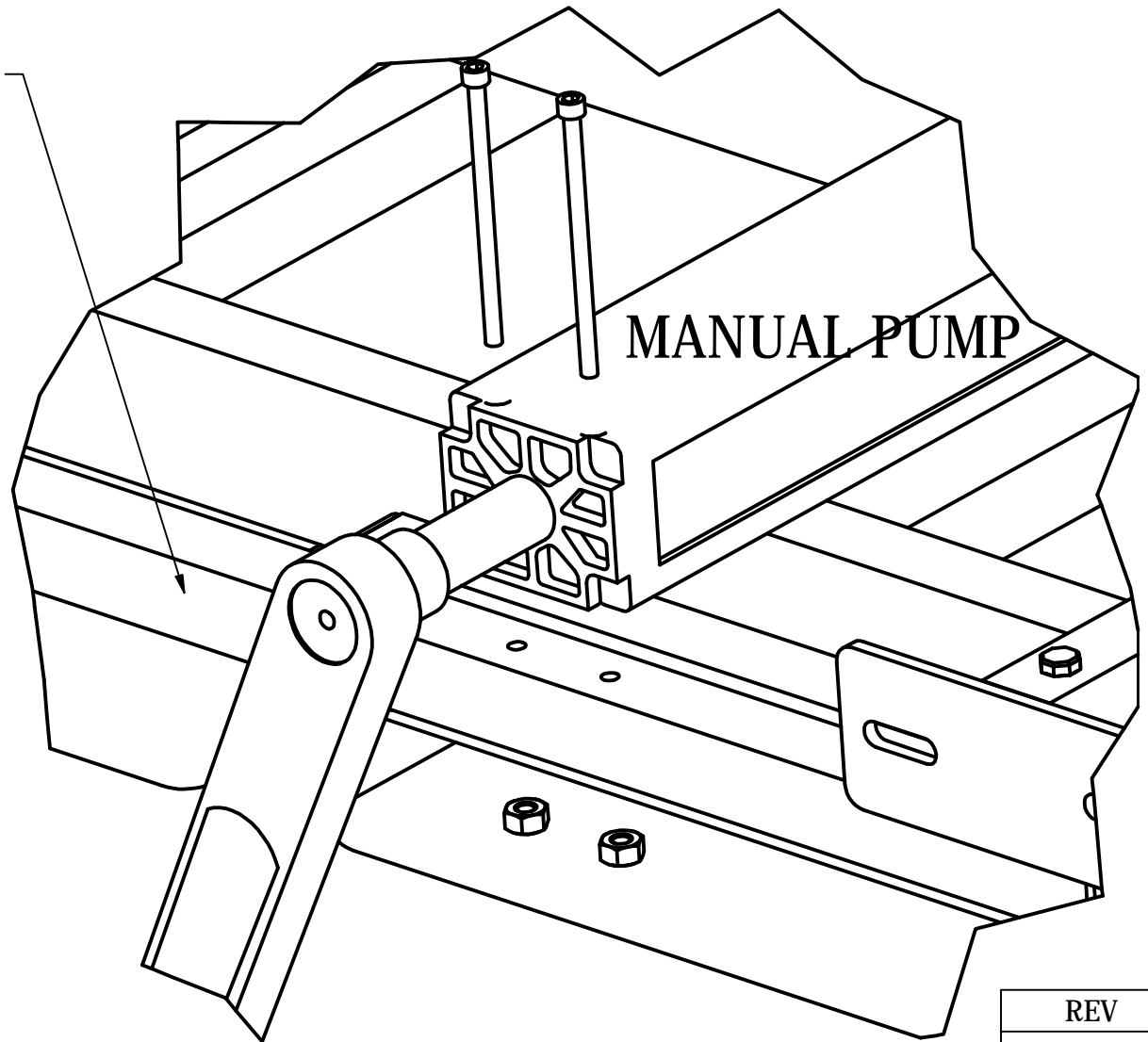
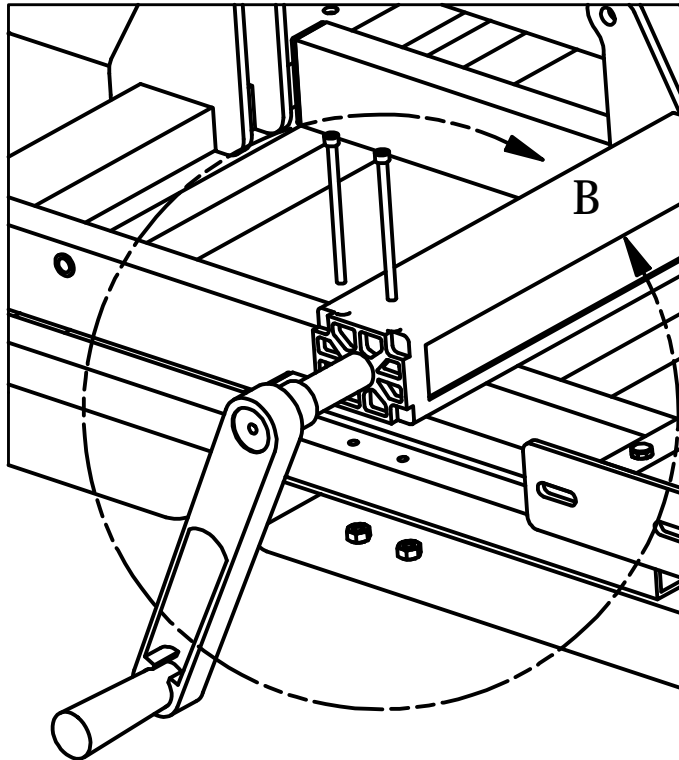

MANUAL PUMP

REV

1

Date
4/4/2019

Drawn By
Rex.Anderson

MANUAL PUMP CONVERSION STEP 6



NOTES

ONCE PUMPS ARE MOUNTED, MAKE SURE THAT NONE OF THE WIRES NEED TO BE RE-ROUTED DUE TO ANY PINCH POINTS

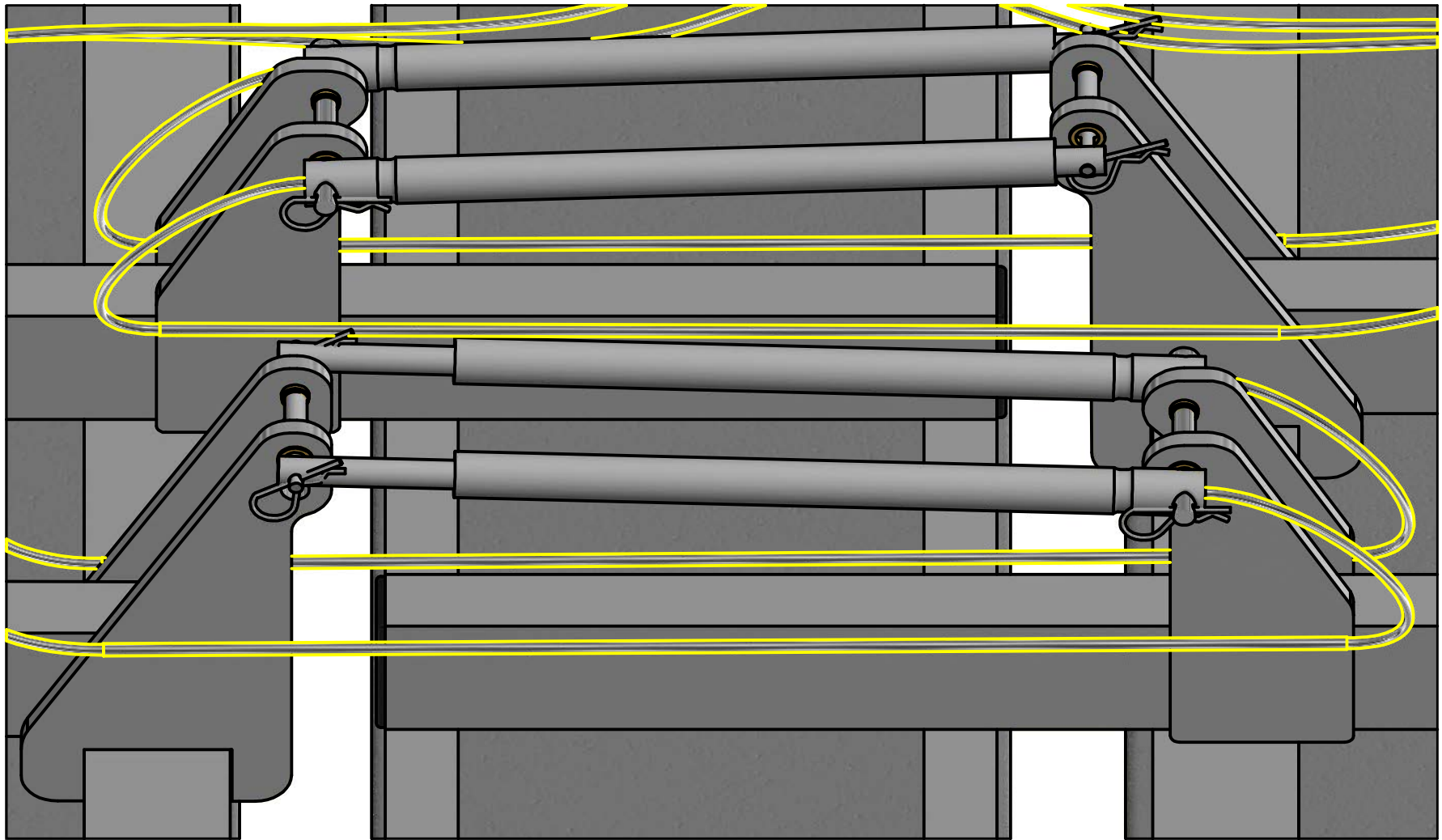

REV

1

Date
4/9/2019

Drawn By
Rex.Anderson

MANUAL PUMP CONVERSION STEP 7



NOTES

IF YOU HAVE A MANUAL ELECTRIC, PLEASE NOTE THAT YOU WILL HAVE TO TAKE THE CONTROL BOX OFF THE HEAD ACTUATOR AND
INSTALL IT ON THE FOOT ACTUATOR

NOW YOU ARE READY TO FLIP BACK OVER ONTO THE SOFA BLOCK AND RE-INSTALL YOUR SIDE PANELS, HEAD AND FOOTBOARD

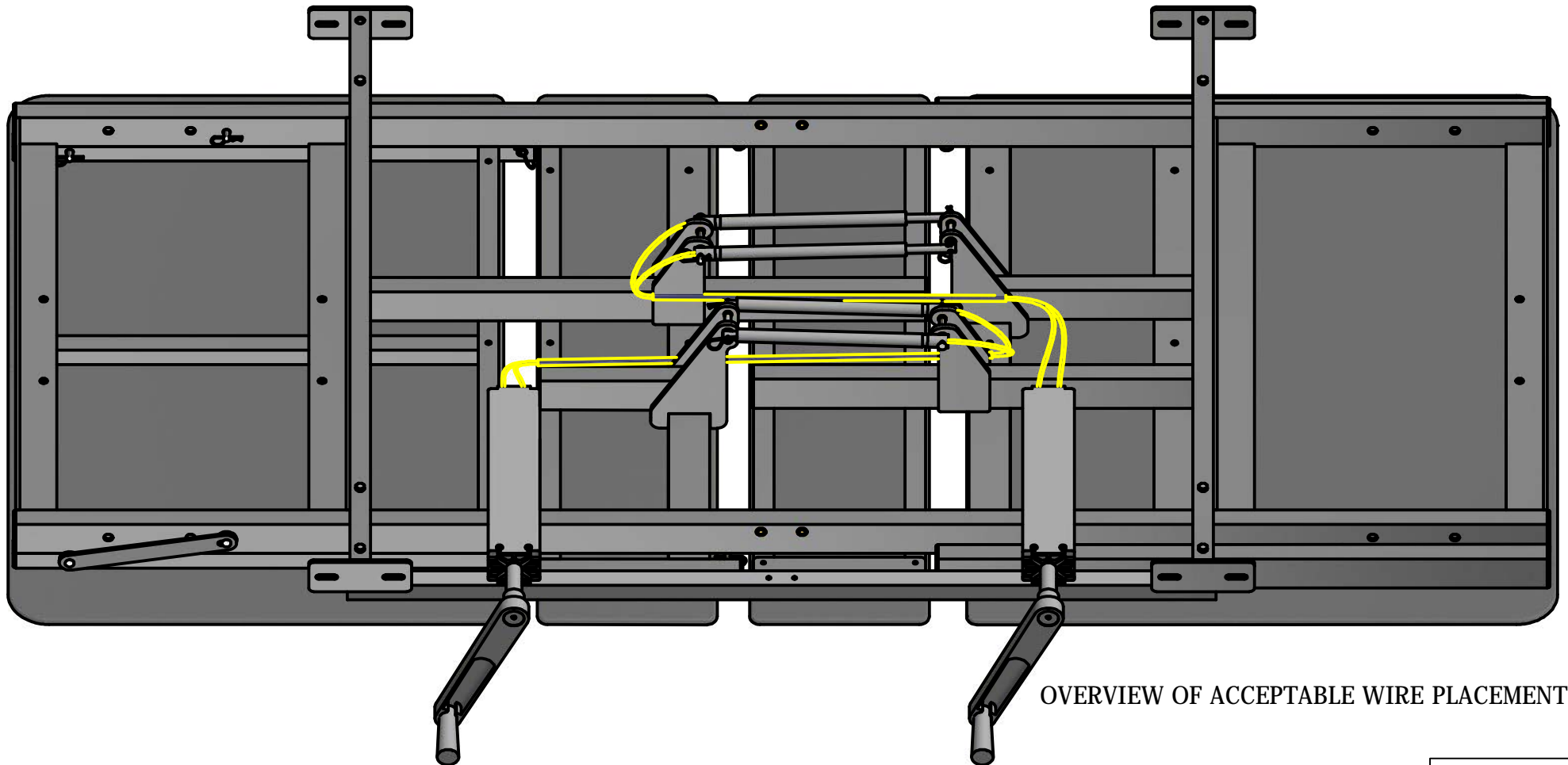

OVERVIEW OF ACCEPTABLE WIRE PLACEMENT

REV

1

Date
4/3/2019

Drawn By
Rex.Anderson

MANUAL PUMP CONVERSION STEP 8



NOTES

IF YOU HAVE A MANUAL ELECTRIC, YOU WILL HAVE TO SWITCH OUT THE CONTROL BOX TO THE FOOT ACTUATOR

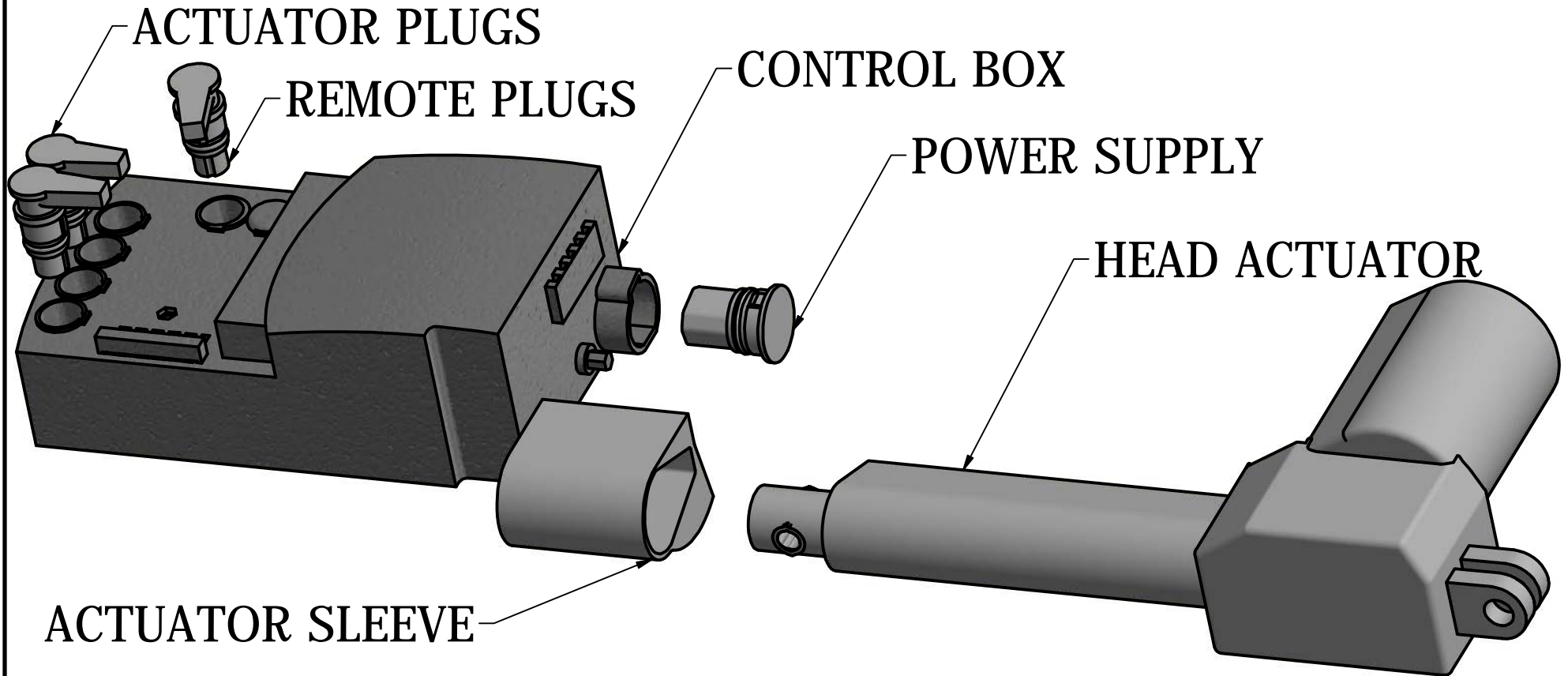

REV

1

Date
4/2/2019

Drawn By
Rex.Anderson

MANUAL PUMP CONVERSION (REFERENCE)